

THE SHOWER LAB

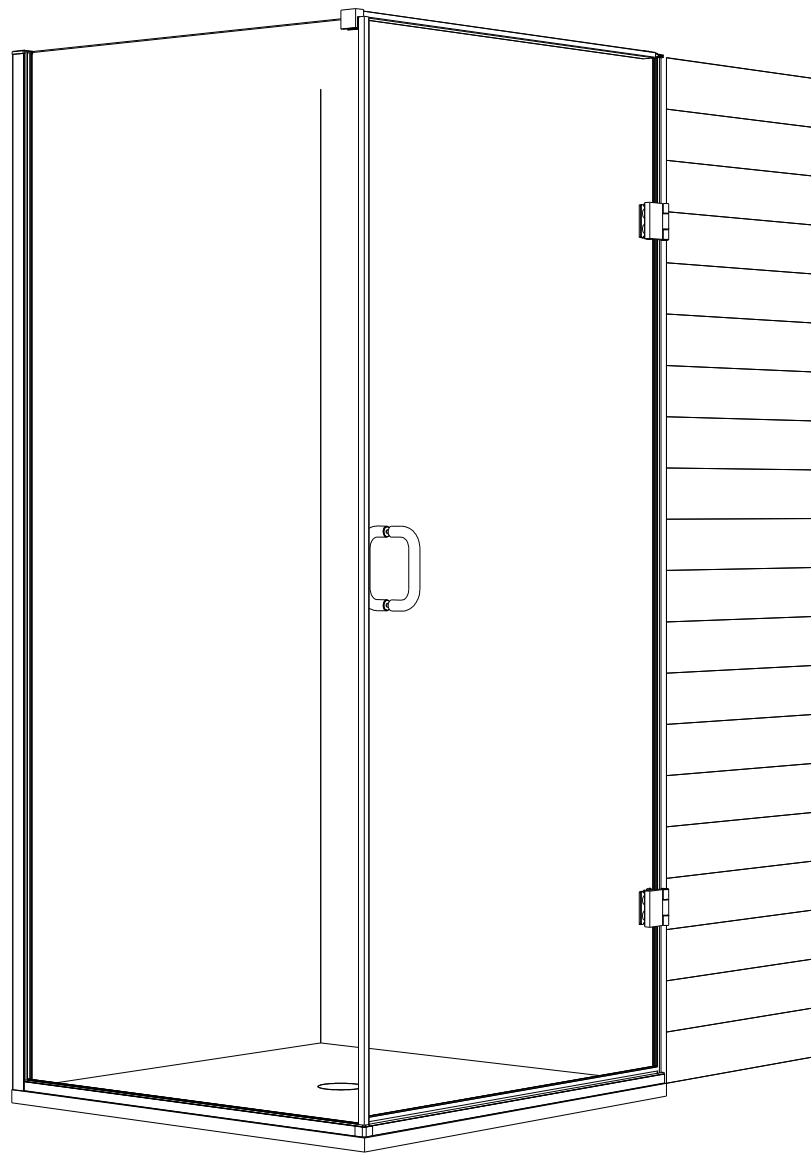

VIEW 06



Illustration - View 06
H1 Handle
Right Hand

IMPORTANT

- This shower screen / enclosure must be installed by suitably qualified individuals. We recommend a minimum of two people for safe assembly of certain sections of this screen.
- Ensure all appropriate safety equipment, especially protective footwear, safety glasses and gloves are used.
- When drilling holes in ceramic tiles, use masking tape to prevent the drill from slipping: DO NOT use hammer action as this will crack the tiles. Use a high quality drill bit to ensure a clean, precise hole.
- Tighten hinges and brackets to the recommended **15.6N**.
- Please leave these instructions with the customer following installation.

PRIOR TO INSTALLATION

- Before disposing of the packaging and prior to commencing assembly, please check all the components to ensure that they have been supplied correctly and are undamaged. Subsequent claims for missing or damaged pieces will not be accepted once the packaging has been disposed of and installation commenced.
- In the event of any queries please contact your supplier quoting the relevant model information.
- The Tray / Tiled floor on which this screen is to be installed must be level on all sides.
- It may be necessary to use alternate fixings to those supplied, depending on the properties of the walls to be fixed to.
- Use the protective corners supplied at all times until the glass is moved to its final position.
- Ensure that the glass is installed correctly, taking care to avoid installing the glass upside down. On certain panels an easy clean coating is applied to one side only, this is clearly marked with a sticker on the non-coated side. The coated surface is to be fitted inwards towards the inside (wet side) of the screen.
- Ensure that all surfaces to be sealed are clean and dry prior to applying the silicone sealant. Use a high grade fungal resistant sealant.
- Allow a minimum of 24 hours after application of the silicone sealant prior to using the screen.

TOOLS & MATERIALS REQUIRED

Junior Hacksaw	Modelling Knife	High Quality Silicone Sealant
Straight Edge (Steel Rule)	Spirit Level	Digital Torque Wrench
Fine Tooth File	Pencil	Tape Measure
Set or Roofing Square	Silicone Gun	Pozi-drive
Masking Tape	Power Drill	Screwdrivers, PZ1&2
	Ø6mm Masonry Drill Bit	Safety Glasses and
	2x Suction Glass Lifters	Gloves

CARE AND MAINTENANCE

(please ensure that these instructions are left with the installed unit)

- We recommend routine cleaning of your screen / enclosure with hot water using a soft cloth, then drying with a dry soft cloth or chamois leather.
Ritec Aftercare for Shower Glass is recommended for best results.
- All glass has been treated with EASY CLEAN glass finish and care must be taken to avoid any abrasive cleaning products that may damage the special surface protection.
- DO NOT use acidic based de-scaler products or products containing bleaches or solvents.

Supplied Parts



Return Panel
x1

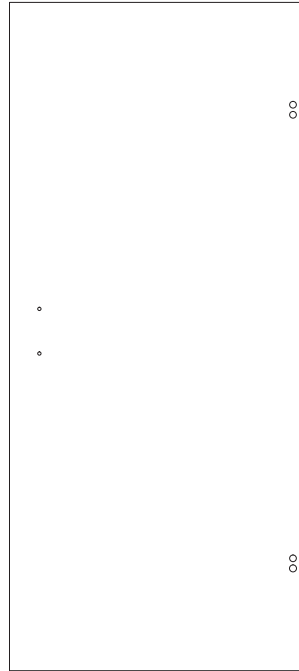

Door
x1

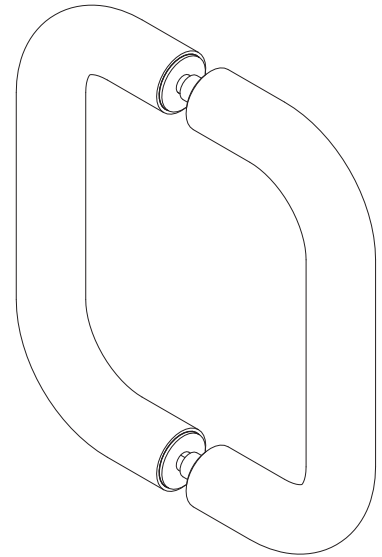

Door Handle
(Option dependant)
x1

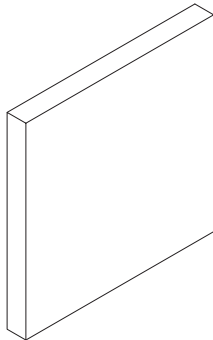

Nylon Block
x1

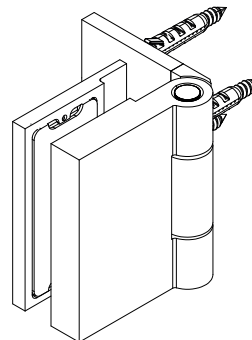

Glass to Wall Hinge
x2

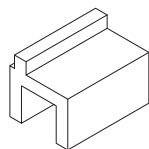

Glass Support
x2

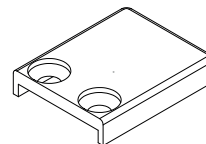

Wall Profile End Cap
x1

Supplied Parts

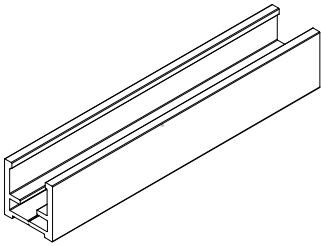

Underframe
x2

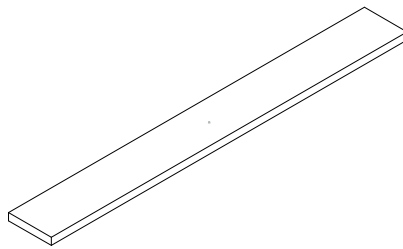

Underframe Gasket
x1

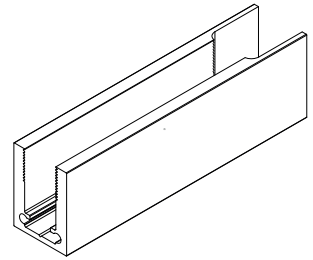

Wall Profile
x1

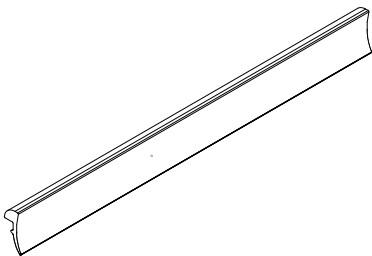

Underframe Wedge Gasket
x2

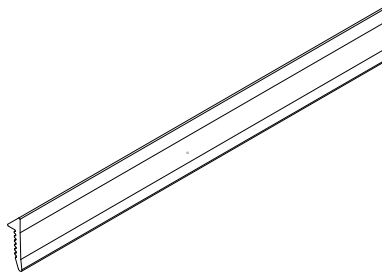

Wall Profile Rigid Seal
x1

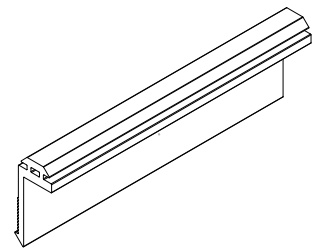

Wall Profile Soft Seal
x1

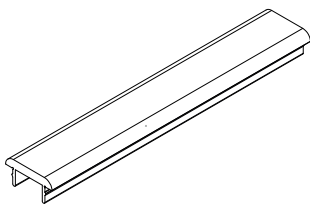

Underframe Top
x1

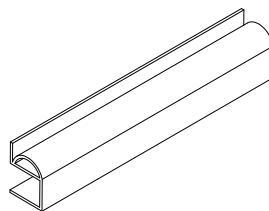

Return Panel to Door Bubble Seal
x1

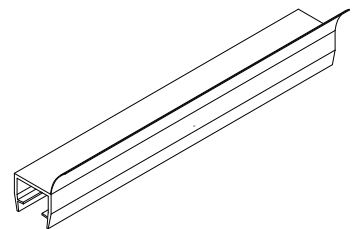

Glass to Wall Seal
x1

Supplied Parts

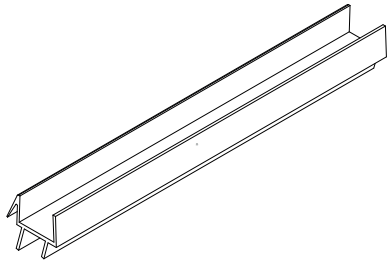

Bottom Door Seal
x1

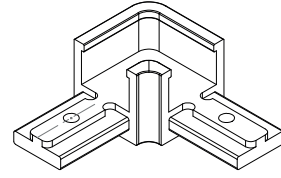

Underframe 90° Connector
x1

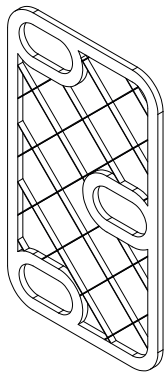

Hinge Template
x1

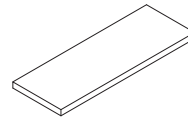

Spacers

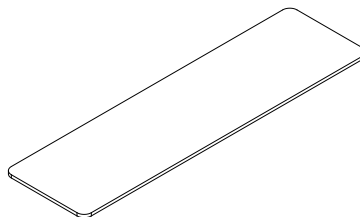

Packers

Supplied Parts

Please use this page to find which stay bar your enclosure has been supplied with.

SB1 - With Glass Clamp

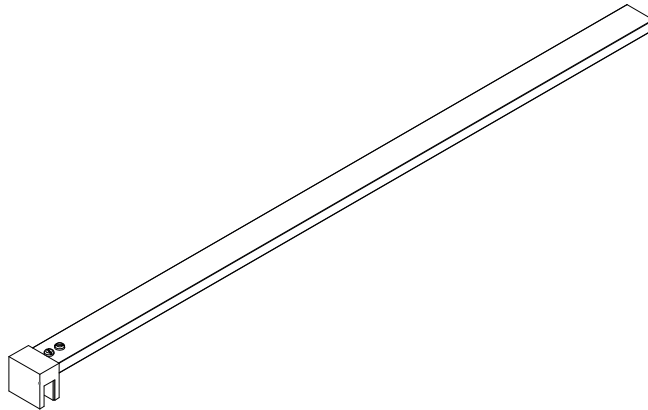

SB2 45° - With Glass Clamp

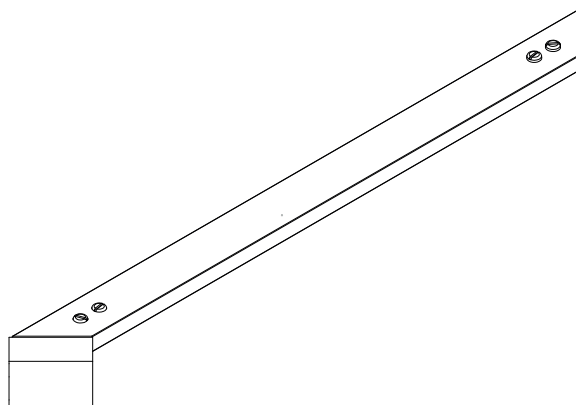

These instructions are for the View 06. An SB1 Stay Bar is used for this illustration.

The following instructions are valid for both the 20mm and 30mm profiles. The 30mm profile is used in the following instructions.

Please use the below diagram to reference the list of parts.

- (A) Return Panel
- (B) Door Panel
- (C) Wall Profile
- (D) Wall Profile End Cap
- (E) Wall Profile Soft Seal
- (F) Wall Profile Rigid Seal
- (G) Underframe Wedge Gasket
- (H) Underframe
- (I) Underframe Gasket
- (J) Bottom Door Seal
- (K) Underframe Top
- (L) Underframe 90° Connector
- (M) Glass to Wall Hinge
- (N) Glass to Glass Return Seal
- (O) Glass to Wall Seal
- (P) Handle (H1 Shown)
- (Q) Stay Bar (SB1 Shown)

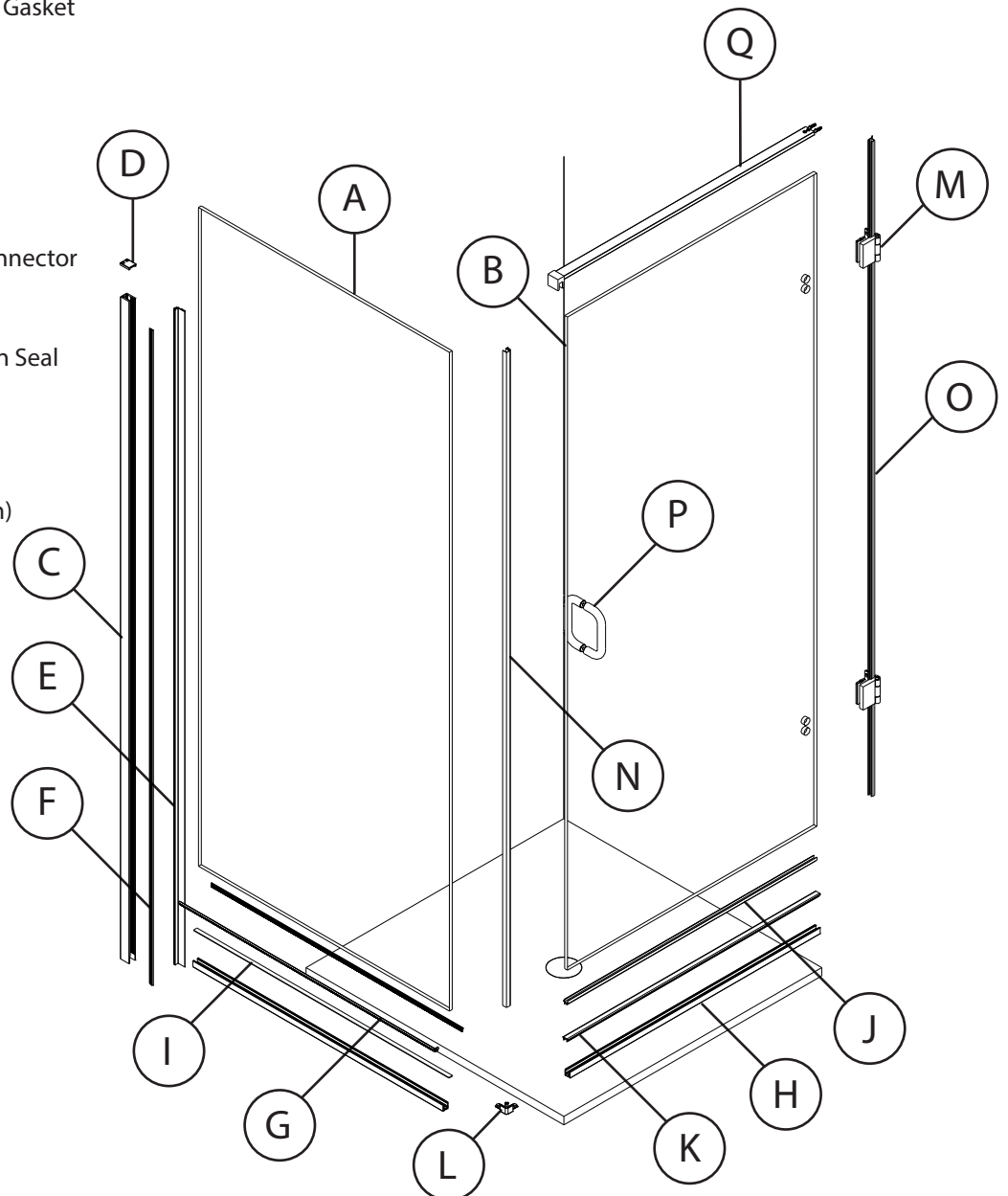

LH

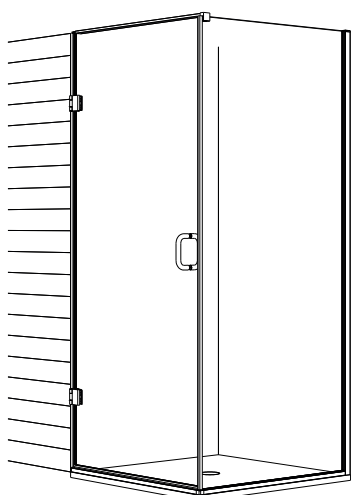

RH

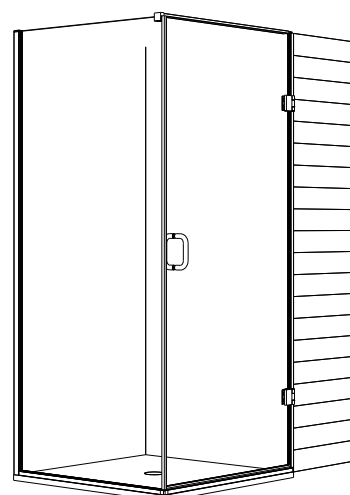

Enclosure dimensions to OUTSIDE of Wall Profiles - See spec below
 Underframe dimensions - (Front Width -3mm for Wall Profile Overlap)

STANDARD ENCLOSURES - 30mm (CH30) Wall Profile

Code	Width	Return	Height	<input checked="" type="checkbox"/>
VR06B7080	700	800	2000	<input type="checkbox"/>
VR06B7090	700	900	2000	<input type="checkbox"/>
VR06B70100	700	1000	2000	<input type="checkbox"/>
VR06B70120	700	1200	2000	<input type="checkbox"/>
VR06B70140	700	1400	2000	<input type="checkbox"/>
VR06B8080	800	800	2000	<input type="checkbox"/>
VR06B8090	800	900	2000	<input type="checkbox"/>
VR06B80100	800	1000	2000	<input type="checkbox"/>
VR06B80120	800	1200	2000	<input type="checkbox"/>
VR06B80140	800	1400	2000	<input type="checkbox"/>
VR06B9080	900	800	2000	<input type="checkbox"/>
VR06B9090	900	900	2000	<input type="checkbox"/>
VR06B90100	900	1000	2000	<input type="checkbox"/>
VR06B90120	900	1200	2000	<input type="checkbox"/>
VR06B90140	900	1400	2000	<input type="checkbox"/>

BESPOKE ENCLOSURES - 30mm (CH30)/ 20mm (CH20) Wall Profiles

If you have a Bespoke Enclosure, reference the Install Sheet for the panel specifications of the Enclosure.

Bespoke Front Width: Door + 32 = Width (0mm Adjustment)

CH30 - Bespoke Enclosure Return Width: Panel + 14 = Minimum Width + 14 = Maximum Width

CH20 - Bespoke Enclosure Return Width: Panel + 14 = Minimum Width + 4 = Maximum Width

01 Position the Underframe parallel to tray edge. If using a raised shower tray, leave a minimum 3mm gap from the edge of the tray (5mm is recommended).

Use tape to mark this dimension.

Repeat for the Return Underframe Profile.

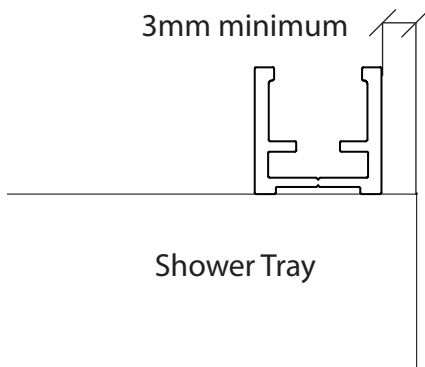

02 Measure the distance from the tape edge to the tiling and take note of this distance.

Repeat for the Return Underframe.

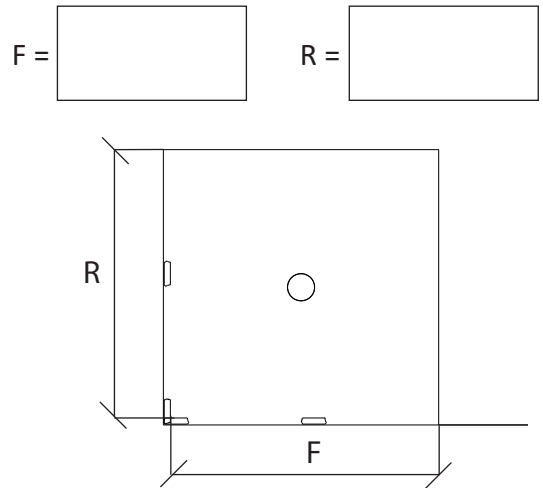

03 Check the dimensions are within the allowed adjustments by referencing the attached adjustment sheet.

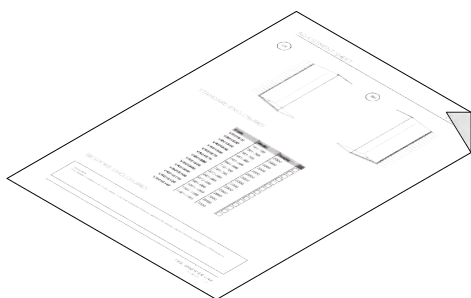

04 Subtract 22mm from the Front and Return Underframe dimension. This is the profile width. Mark this measurement on the Underframe.

Cut squarely using a chop saw.

Use a fine toothed file to remove any burrs, be careful not to damage the surface finish.

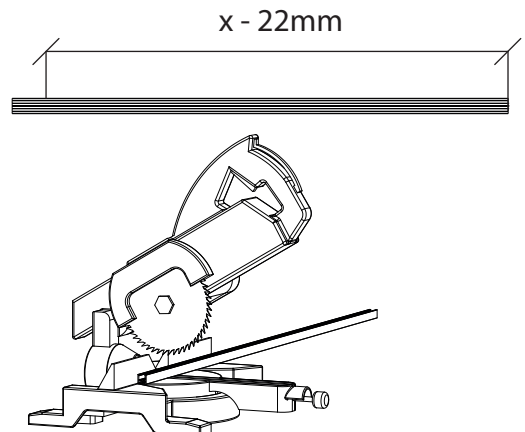

05 Connect the Underframe Profiles together using the Underframe 90° Connector and supplied screws.

Add a small amount of silicone to the ends of the Underframe before connecting.

Remove the backing strips from the self adhesive and fix firmly to the tray.

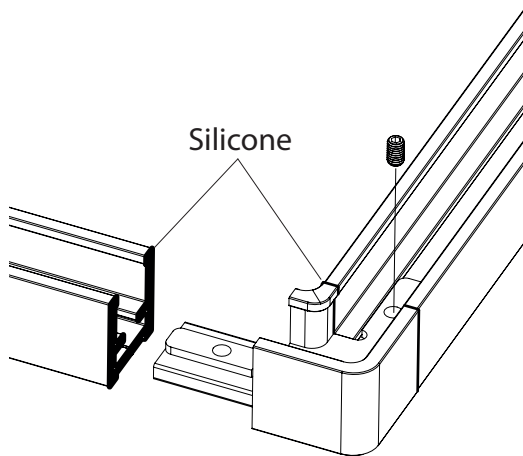

06 Place the Underframe Gasket where the glass will sit into the Underframe and butt up against the wall.

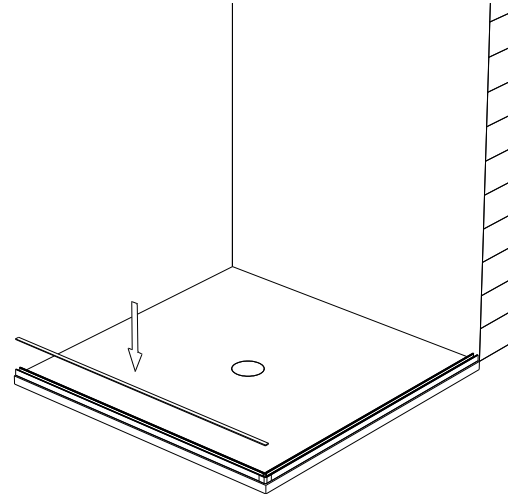

07 Place the Wall Profile over the Underframe and up against the wall.

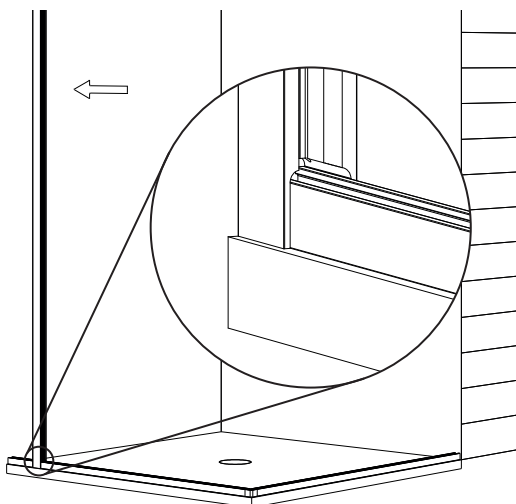
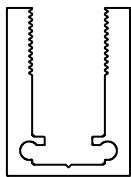

08 Ensure the Wall Profile is vertical by using a spirit level. Mark the positions of the pre-drilled holes.

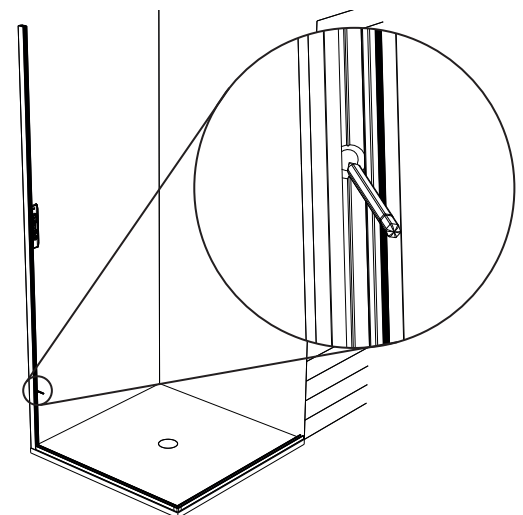

09

Remove the Wall Profile and drill holes on each wall with a 6mm high quality drill bit for a clean and precise hole.

Fully insert the wall plugs.



Professional Tip
 If drilling ceramic tiles, place masking tape on the tiles before marking and drill through the tape to prevent the drill bit from skidding.

 DO NOT use Hammer Action as this will break the tiles.

10

Pre drill the No 6 screws in to the Wall Profile to create the thread for the Top Cap, then REMOVE screws.

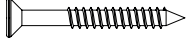
Fix the Wall Profiles to the wall using the No 8 screws.

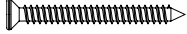
-   (No 8) Profile - Wall
-   (No 6) Profile - Top Cap

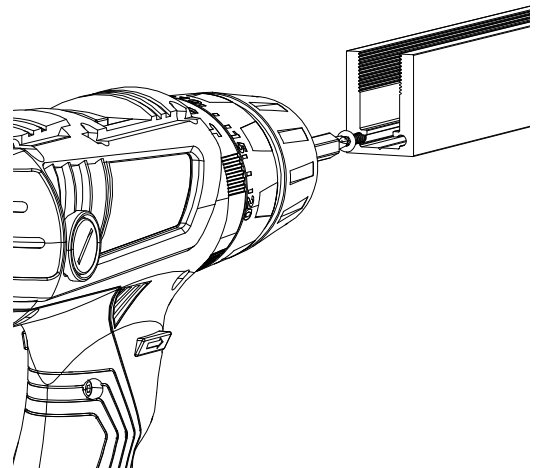

11

Take the Wall Profile Soft Seal and push the seal into place on the Wall Profile to cover the screws.

Ensure the fin is on the inside (wet side).

Use the Nylon Block to help.

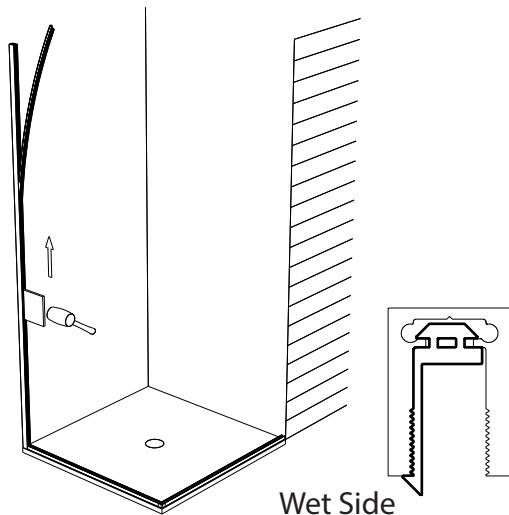

12

Using purpose built "Glass Lifters", position and sit the Return Glass Panel on to the Underframe Gasket and push against the Wall Profile.

Note the orientation and position of the Panel, this can be determined by any holes or attached labels.

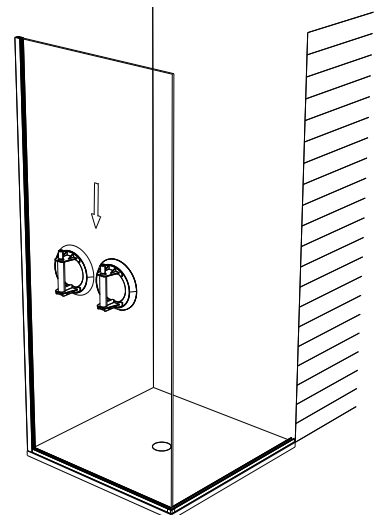

13

Remove and replace the Panel adding or subtracting spacers as necessary to level the Panel (to a maximum height of 5mm inside the Underframe).

Check the Panel is level using a Spirit Level.

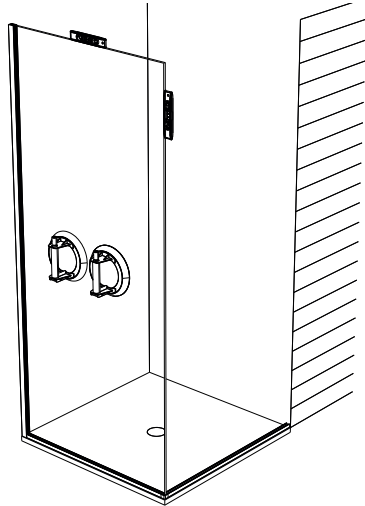

14

Check the Return Panel has a 4mm gap between the Panel and the front face of the Front Underframe.

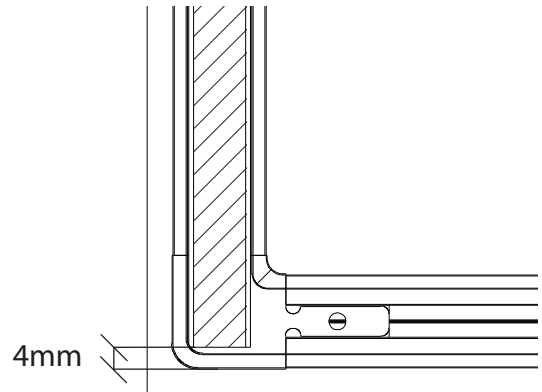

15

If the Wall Profile is flush with the Glass Panel, move on to step 17.

If the Wall Profile is not flush with the top of the Glass Panel, mark the Wall Profile. Using a straight edge, mark where the wall channel needs to be trimmed.

To protect the channel finish, it is recommended to mark on masking tape.

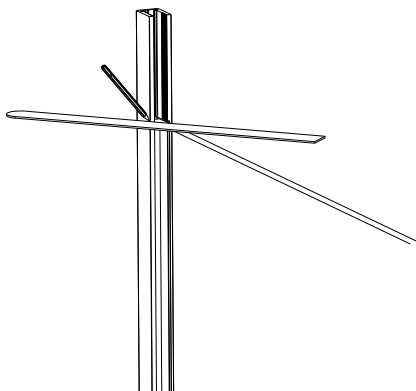

16

Remove the Panel, Wall Profile Soft Seal, and the Wall Profile.

Trim the Wall Profile.

Use a fine file to remove any burrs. Be careful not to damage the channel finish.

Re drill the screws in to the Wall Profile and remove after drilling.

Reinstall the Wall Profile and Wall Profile Soft Seal.

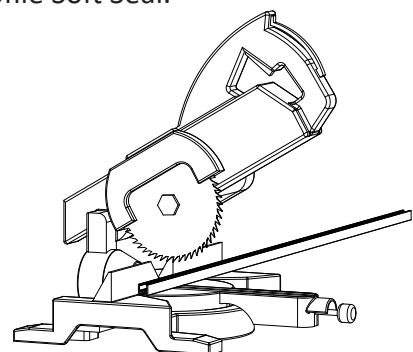

17

If the Glass is still in place, remove it.



Add silicone in the corner where the Wall profile Meets the Underframe at the back.

Re-install the Glass.

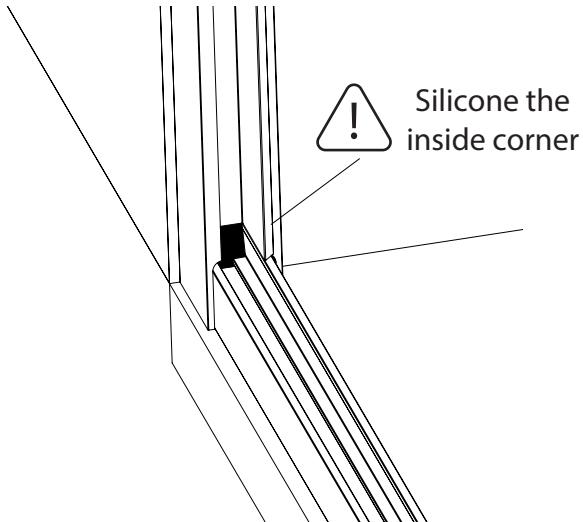

18

Ensure there is adequate glass in the Wall Profile. (6mm is minimum)

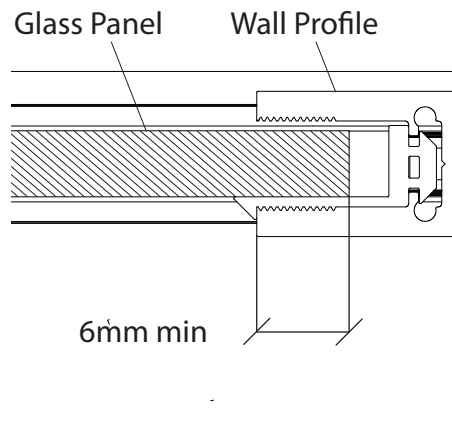

19

To centre the panels, add 1mm Packers on both sides of the Inline Panel in the Underframe.

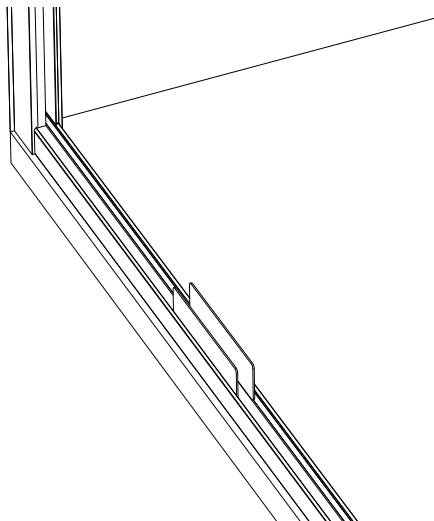

20

Apply the Rigid Seal to the dry side of the Wall Profile starting from the archway of the Wall Profile up to the top.

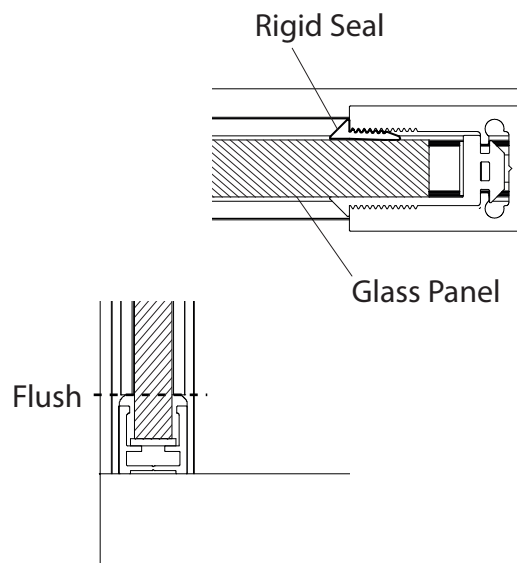

25

Gently tap the Wall Profile Rigid Seal into place using a rubber mallet with the Nylon Block to protect the Glass and the Wall Profile.

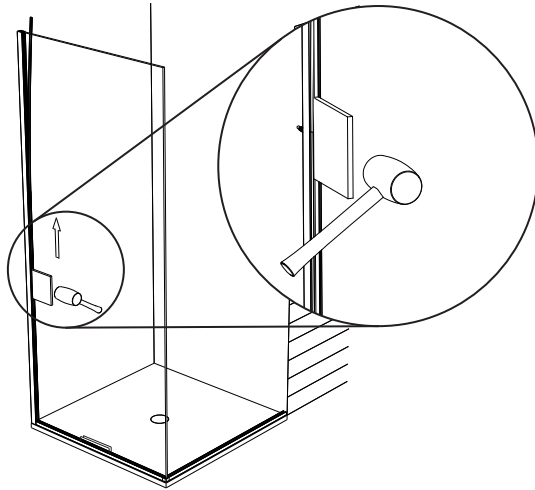

26

Trim the Wall Profile Seal at the top face of the Wall Profile using a blade.

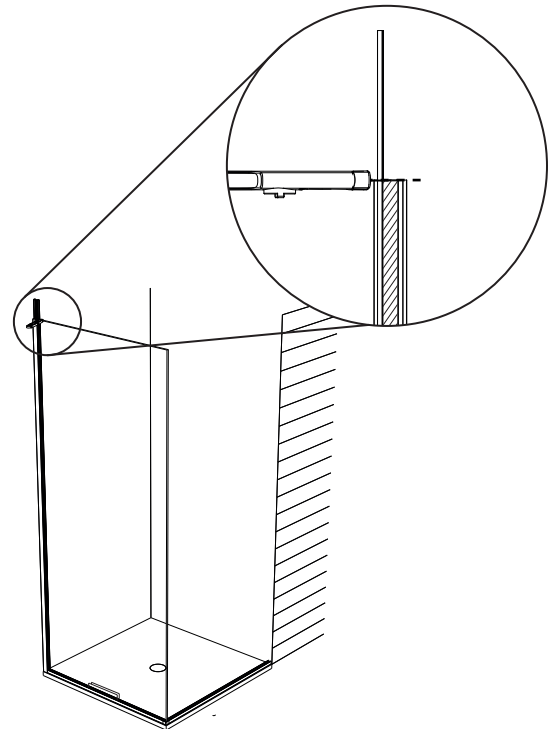

27

Check which Stay Bar configuration your screen has been supplied with and refer to the relevant instructions below. (You can find this out at the front of these instructions).

Config A - SB1

Page 07

Config B - SB2

Page 10

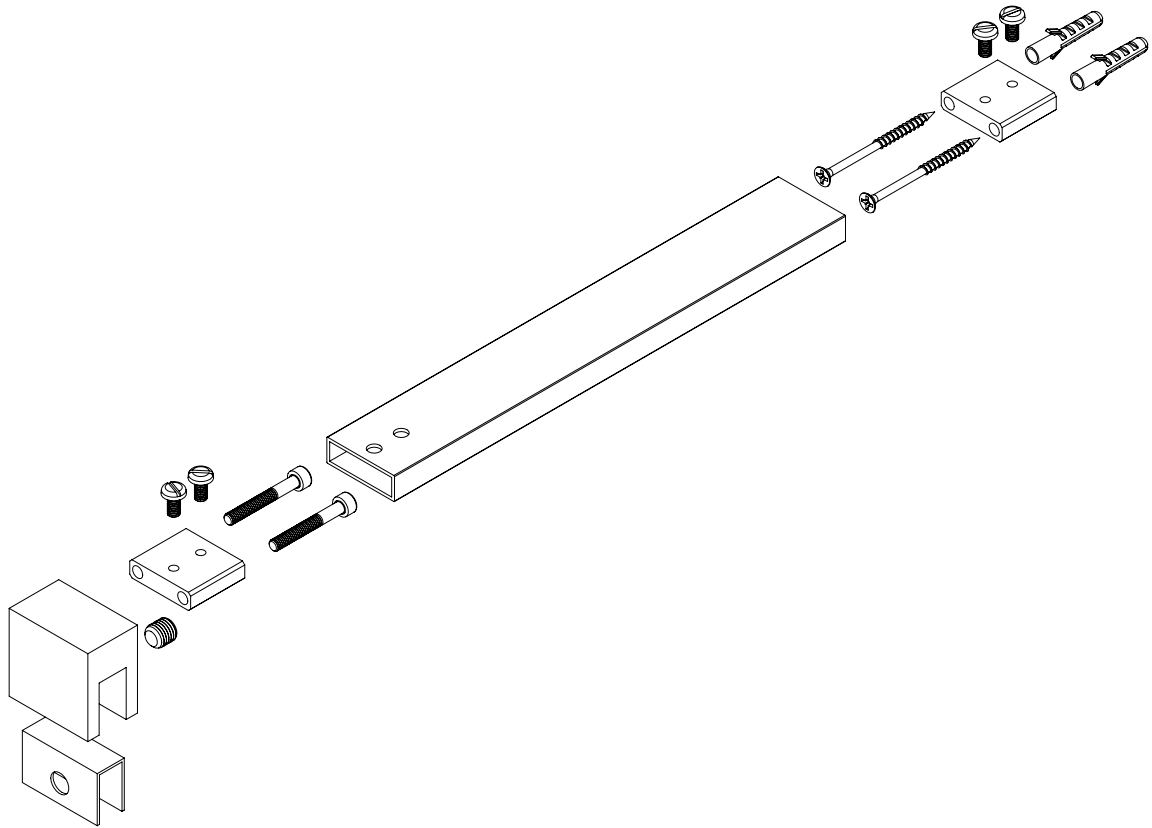

A1 Measure the distance from the inside face (wet side) of the Return Panel to the wall opposite. Ensure this measurement is truly horizontal.

A2 Mark the final dimension on the Stay Bar Tube, wrapped with some masking tape. Carefully use a chop saw and fine file to cut and finish the edge.

Subtract 6.5mm to get your final dimension.

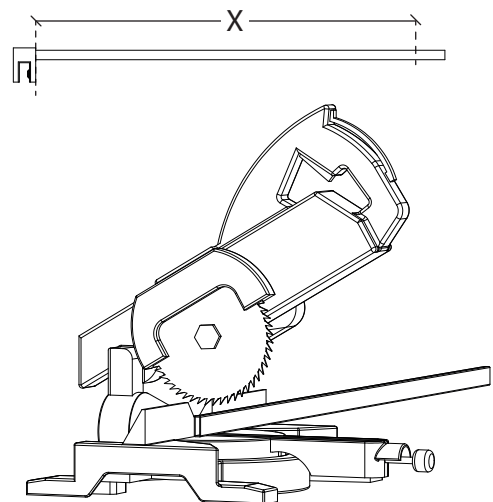
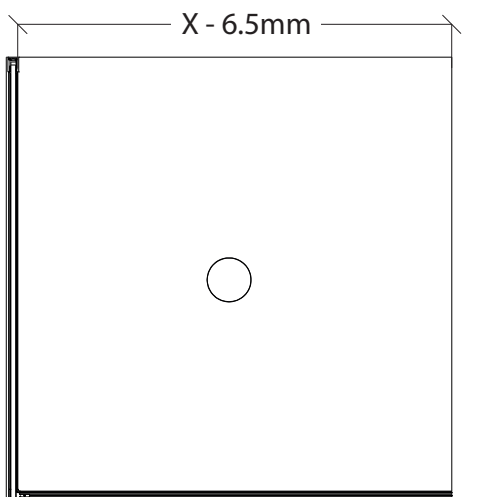

A3 With masking tape applied, place the supplied Stay Bar Jig firmly at the trimmed end of the Stay Bar and mark the 2 holes with a pen.

Drill holes using a 5mm drill bit.

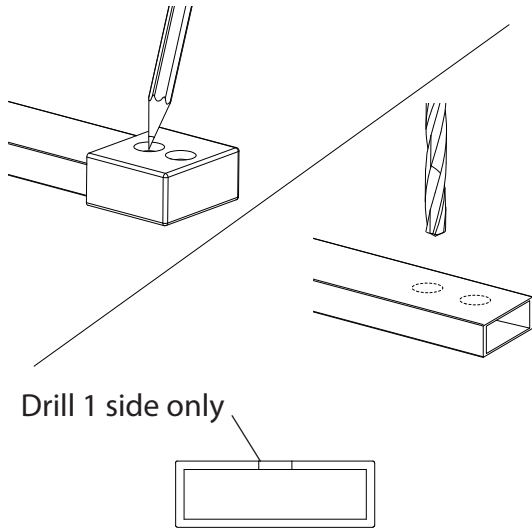

A4 Assemble the Glass Clamp to the Stay Bar as shown.

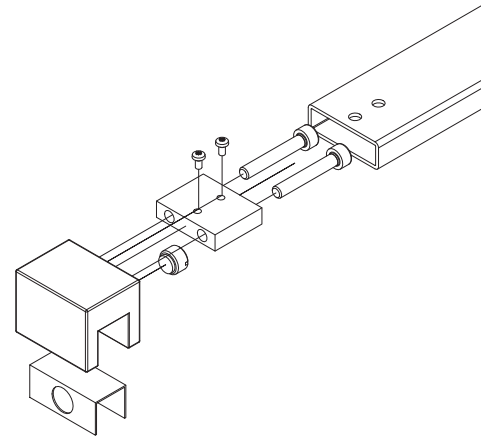

A5 Secure the Glass Clamp over the panel making sure the glass is fully inserted into the groove.

A6 Ensure the Stay Bar is square and level.
Mark the end location on the wall.
Remove the Stay Bar.

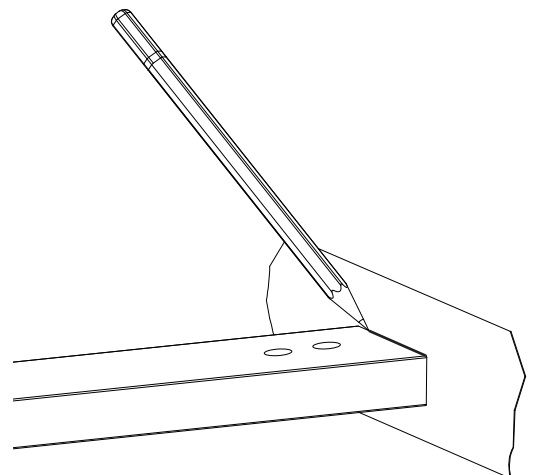
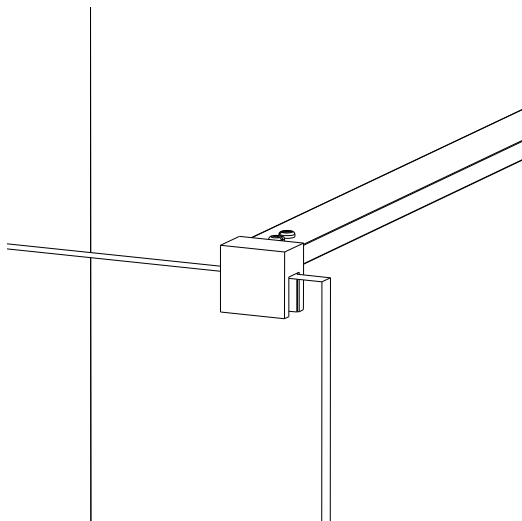

A7 Position the Stay Bar Connector central to the marking. Mark the holes for drilling. Use masking tape on the tiles to help.

A8 Using a 5mm high quality drill bit for a clean and precise hole, drill the marked areas, fully insert the wall plugs and fix the Connector to the wall.

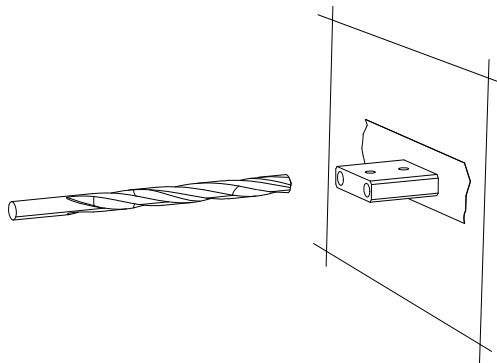

Professional Tip
 If drilling ceramic tiles, place masking tape on the tiles before marking and drill through the tape to prevent the drill bit from skidding.

DO NOT use Hammer Action as this will break the tiles.

A9 Fix Glass Clamp over the Glass and attach the Stay Bar to the Wall Connector with screws provided.

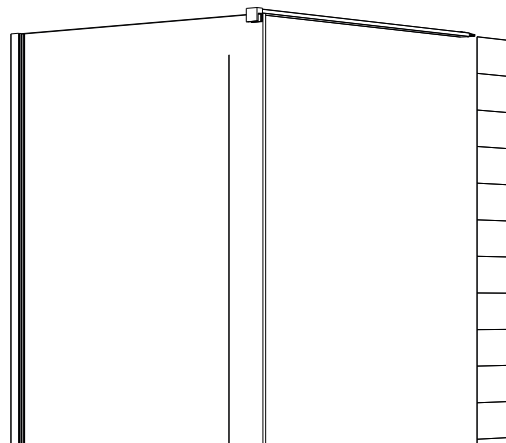

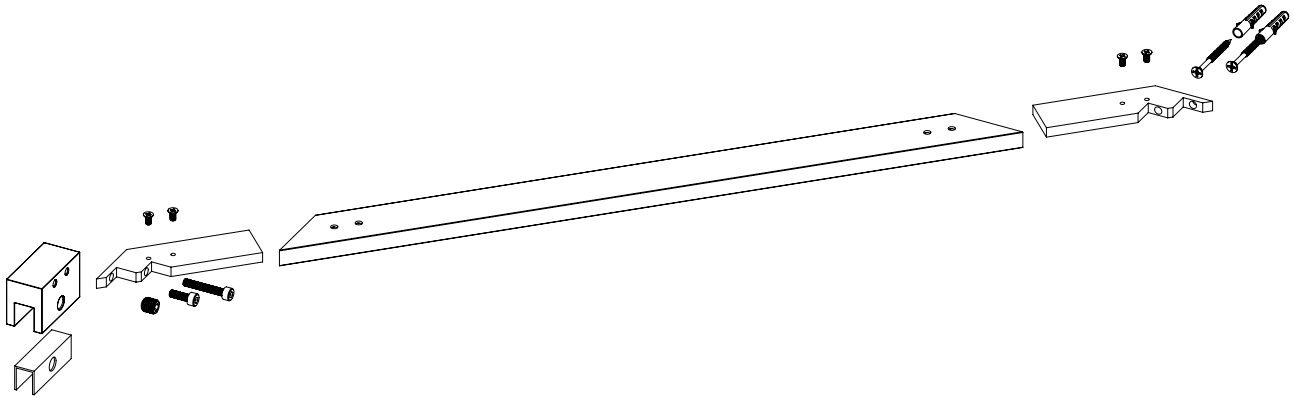

B1 Assemble the Glass Clamp to the Stay Bar.

B2 Secure the Glass Clamp over the panel, ensuring it is flush against the wall (tile).

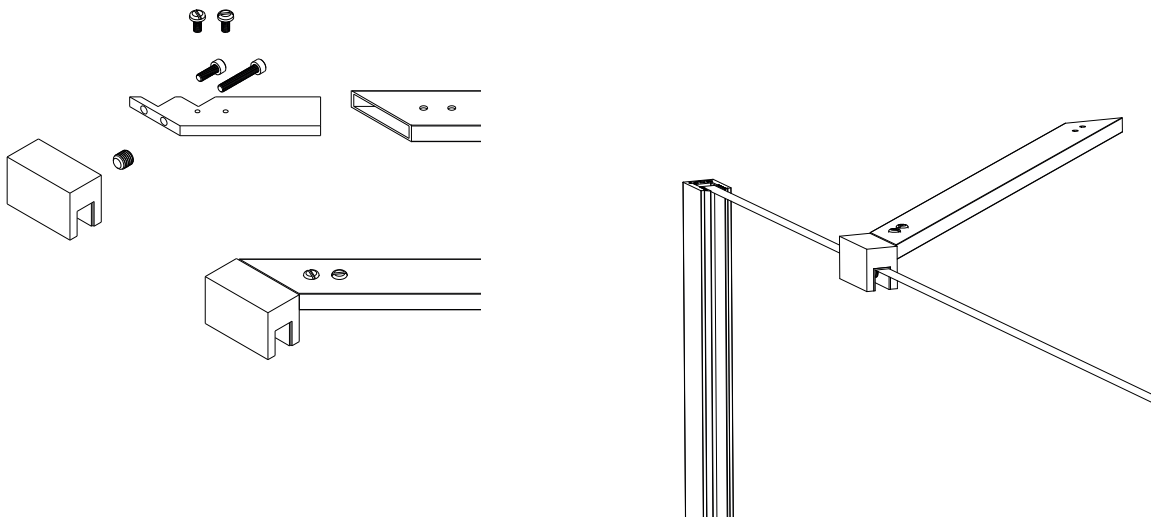

- B3** Ensure the Stay Bar is level and square.
Mark the location on the wall and remove the Stay Bar.

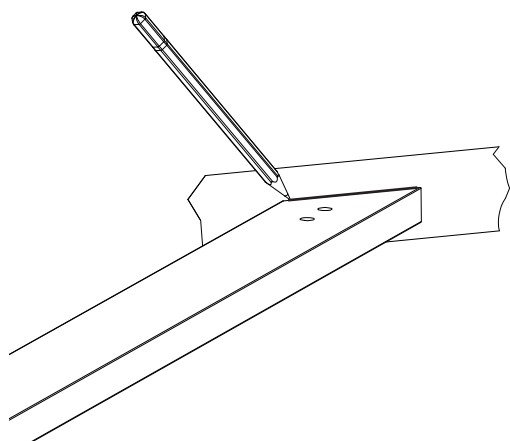

- B4** Position the Stay Bar Connector central to the marking. Mark the holes for drilling.

Use masking tape on the tiles to help.

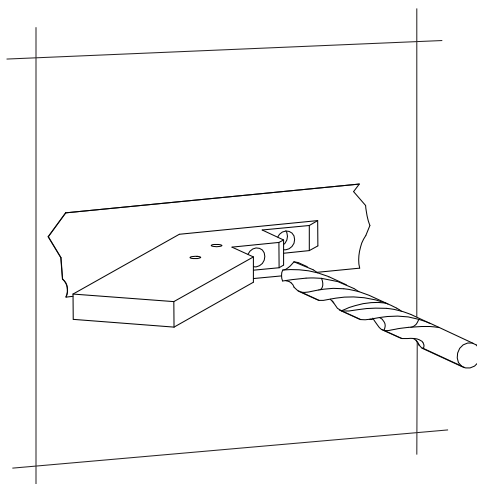

- B5** Using a 5mm high quality drill bit for a clean and precise hole, drill the marked areas, fully insert the wall plugs and fix the Connector to the wall.

- B6** Fix Glass Clamp over the Glass and attach the Stay Bar to the Wall Connector with screws provided.

Professional Tip
 If drilling ceramic tiles, place masking tape on the tiles before marking and drill through the tape to prevent the drill bit from skidding.

DO NOT use Hammer Action as this will break the tiles.

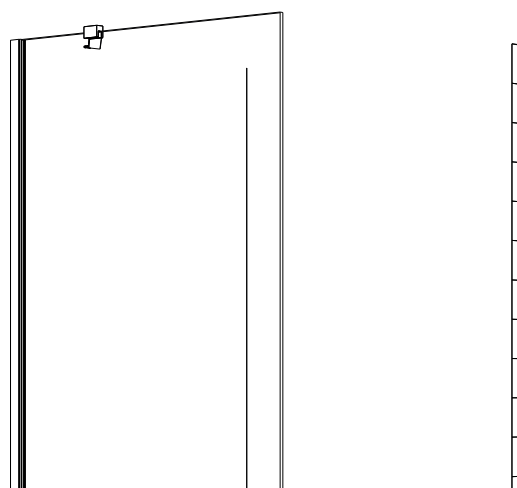

28

Measure the distance between the wall and the inside face (wet side) of the Return Panel.

Mark and cut the Underframe Top.

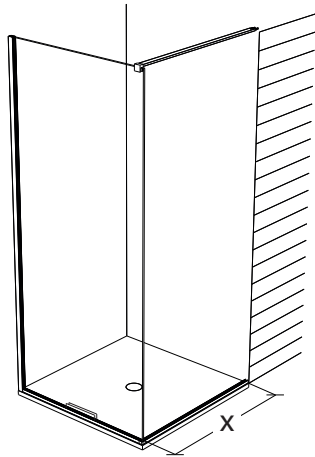

29

Snap the Underframe Top on to the Underframe.

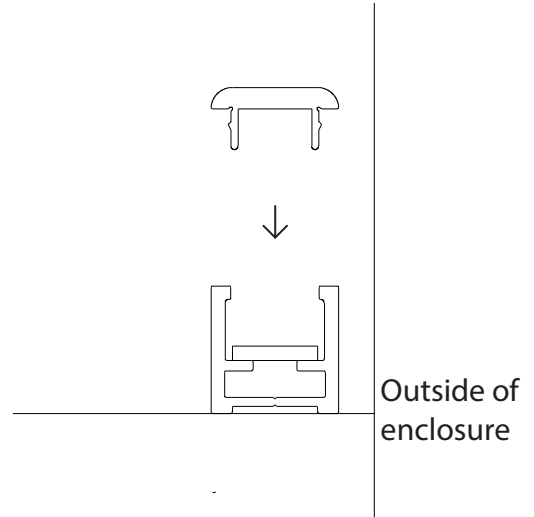

30

Remove Packers and feed the Underframe Wedge Gasket into the archway gap of the Return Panel and trace along the Glass on both sides.

Trim the Wedge Gasket where it meets the Underframe Top.

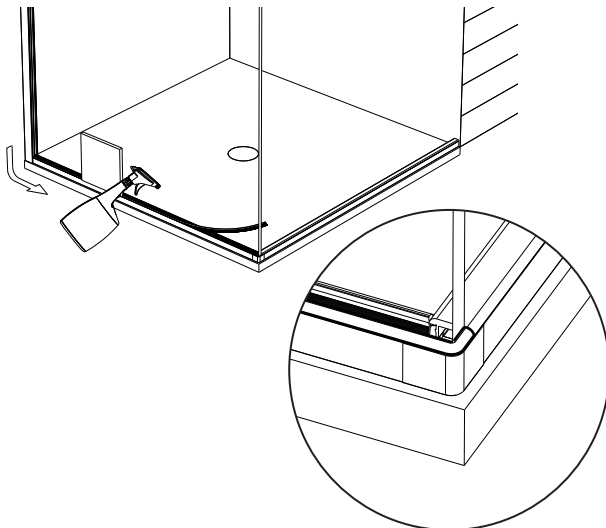

31

Loosely assemble the two 90° Glass to Wall Hinges onto the door. Take note of which way your Hinges move.

The face that attaches to the wall should be located inside the enclosure.

Check the orientation of the Cover Plates. Adjust Clamping Plate to Suit.

Evenly tighten the screws until the Gaskets are just "nipping" the glass.

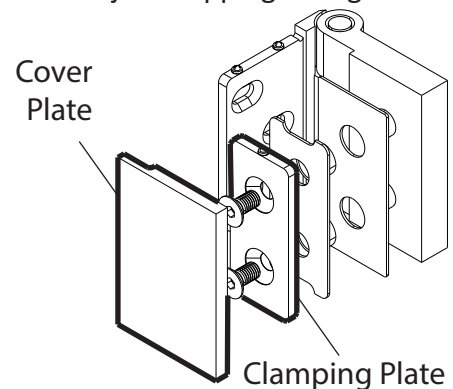

32 Attach the Return Panel to Door Bubble "h" Seal to the Return Panel.

Check the orientation is correct.

Leave the Seal oversized. This will be trimmed later.

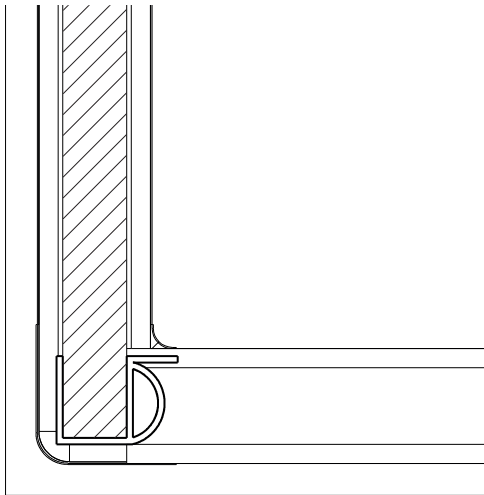

33 Place the Glass Supports over the Underframe as shown. With one person inside the enclosure, position the Door onto the supports.

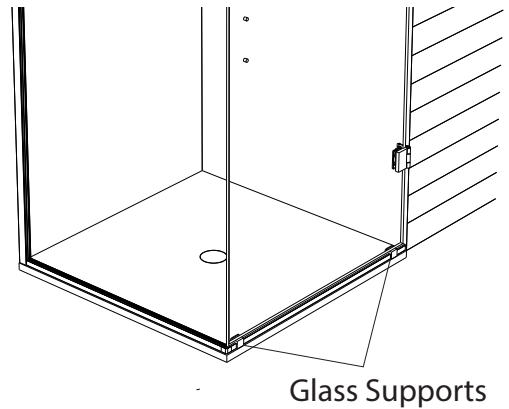

34 Add Spacers to the Glass Supports in order to level the Door.

With someone inside, carefully replace the Door onto the Supports.

Check all Panels are level and square and that the Seals touch fully.

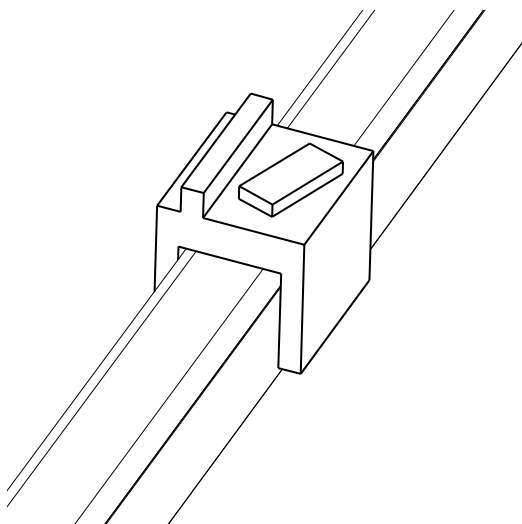

35 Check there is a gap of 9mm between the edge of glass and tile.

Ensure the Door is vertical and level.

Mark the accessible holes where the Hinges will be attached to the wall.

It is recommended to use masking tape on the tiles to mark.

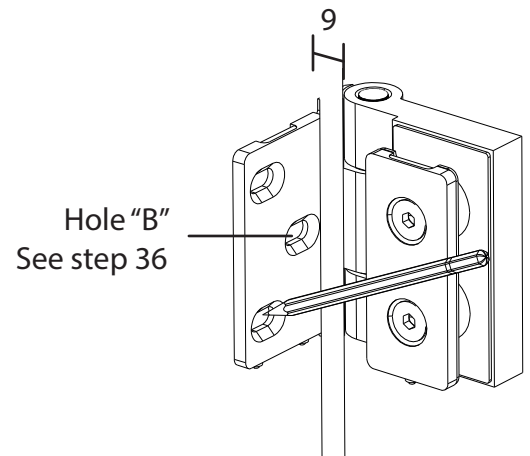

36

Lift the Door out and safely put to one side.

Use the supplied Marking Template to locate Hole "B".

Use masking tape on the wall to mark the measurements.

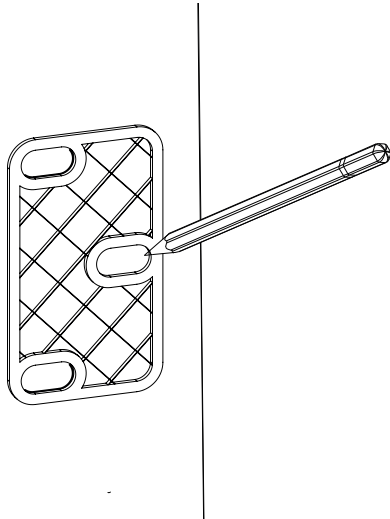

37

Using a $\varnothing 6\text{mm}$ high quality drill bit for a clean and precise hole, drill all holes and fully insert the wall plugs.

Professional Tip

If drilling ceramic tiles, place masking tape on the tiles before marking and drill through the tape to prevent the drill bit from skidding.

DO NOT use Hammer Action as this will break the tiles.

38

Ensure the Door Supports are still in place.

Carefully lift the door back into position and securely attach the Hinges to the wall.

Make sure the screws are flush with the bracket face.

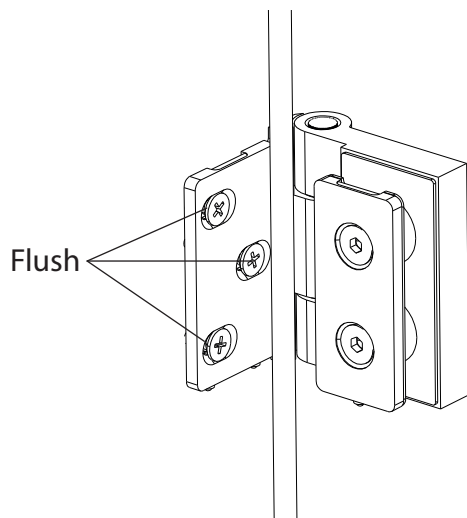

39

Measure the width of the Door and trim the Bottom Door Seal accordingly with a fine toothed junior hacksaw.

Attach the Seal ensuring the Seal is correctly oriented.

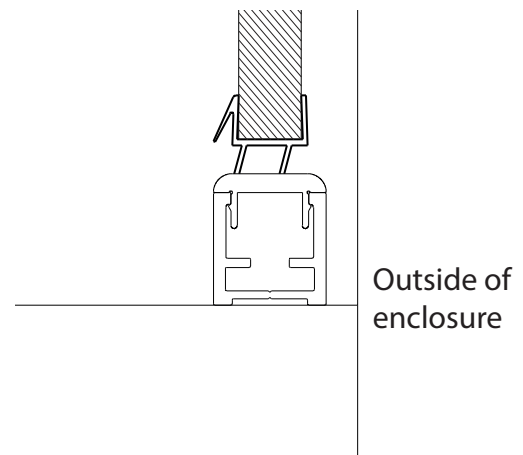

40

Check the Glass to Wall Seal orientation and trim a notch to fit around the Bottom Door Seal.

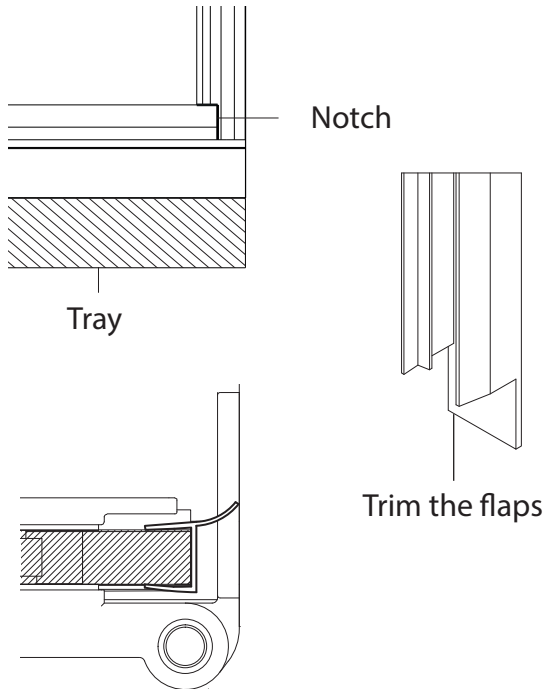

41

With a sharp modelling knife, cut the Glass to Wall Seal tail above and below the 90° Glass to Wall Hinges as shown.

Take care to get these cuts as close to the hinges as possible to allow the Seal to flex around the Hinge without leaking.

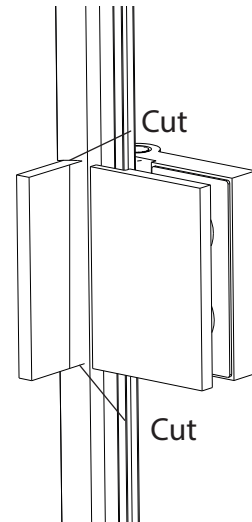

42

Push both Vertical Seals down as far as they can go.

With a straight edge, mark where the Seals will be trimmed. Remove the Seals and trim with a fine toothed junior hacksaw so they are flush with the tops of the Glass Panels.

Replace the seals.

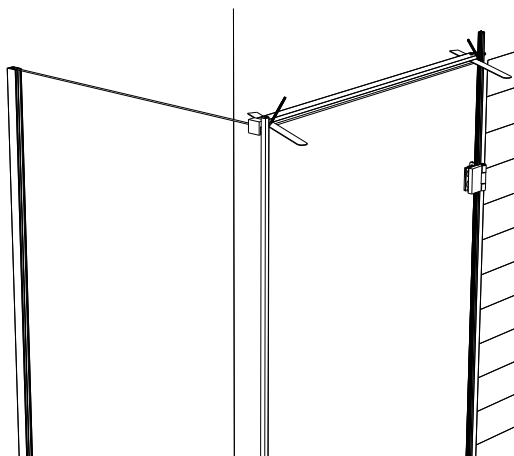

43

Attach the Handle if included. Secure in place with the grub screws provided.

The Handle should be oriented so that the grub screws are not visible when looking down on the handle.

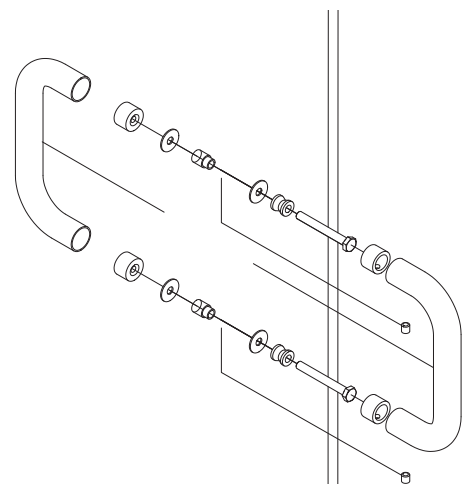

44 Apply the Wall Profile End Cap to the top of the Wall Profile and fix in place using self tapping screws.

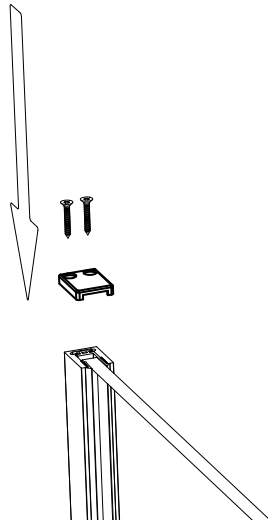

45 Using a sharp modelling knife, trim any excess gasket material from the Hinges that may have squeezed out when tightening.

Take care not to scratch the glass surface.

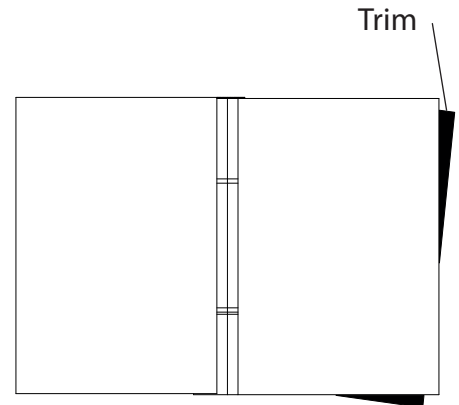

46 Tighten all screws.
Fit all Cover Plates to the Hinges.

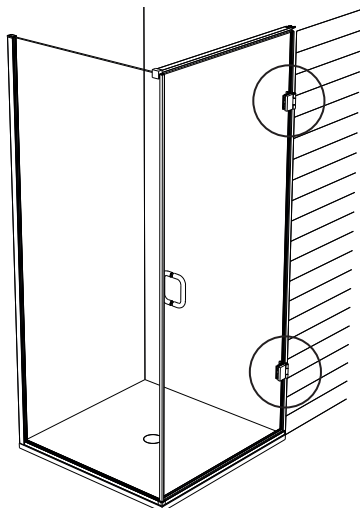

47 Apply silicone sealant along the wall and floor, all around the outside of the Underframe and Wall Profiles.

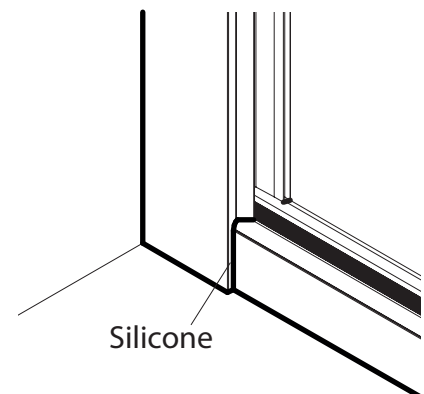
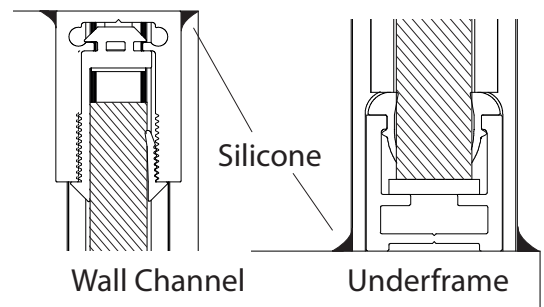

48

Apply silicone to the edge of the Underframe Top where it meets the Return Panel.

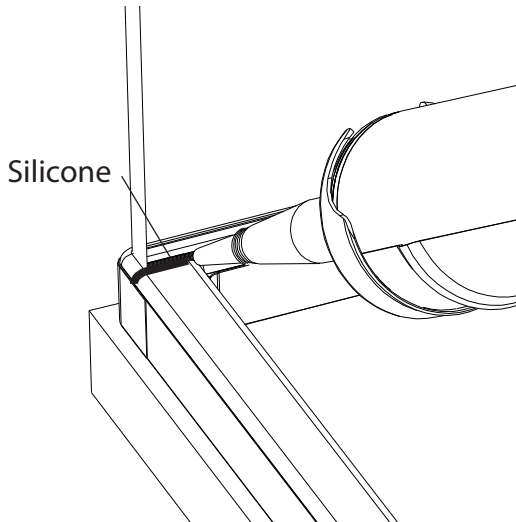

49

Check silicone has been applied to all the below outside areas.

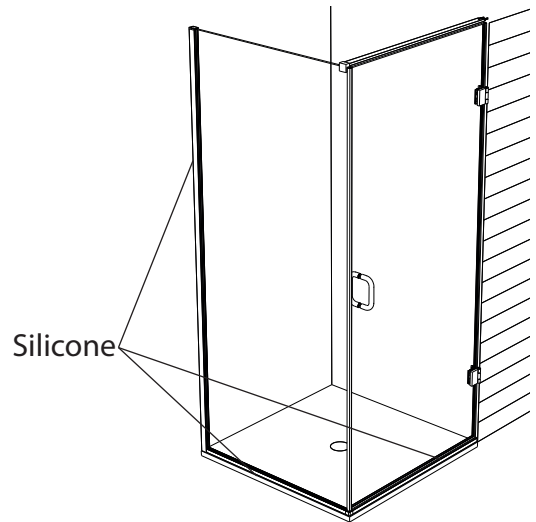

50

Check silicone has been applied to all the below inside areas.

Let the silicone sealant cure for 24 hours.

